



The Ballantyne Hotel

Featuring 200 richly appointed guest rooms and 14 suites and more than 30,000 square feet of elegant event space, The Ballantyne Hotel sets the mark for luxury and service in Charlotte, North Carolina. Our experienced sales and catering team can assist you in planning effortless events, from intimate gatherings to elaborate celebrations.



The Lodge at Ballantyne

With 36 rooms and 4,000 sq ft of event space, The Lodge provides a more discreet atmosphere. From training sessions and corporate retreats to weddings and family reunions, this space can be rented in its entirety and easily accommodate groups in an inviting and rustic setting.

The Pool at Ballantyne

Complete with a chic lounging area, two lit tennis courts and appealing event space, the pool's soothing setting provides a convenient escape. Customized accents can help transform the poolscape into a magical venue with unlimited possibilities for a corporate dinner or social event for up to 500 guests.

The Golf Club Pavilion

The Golf Club at Ballantyne is committed to providing the finest facilities and services for golf tournaments and outings. The Golf Pavilion is an ideal location for entertaining groups. With extensive food and beverage options and full audiovisual capabilities, the pavilion can accommodate a 50-person seated dinner or up to 100 people for a reception.



The Cottage at Ballantyne

Adjacent to The Lodge, The Cottage is a beautifully decorated four-bedroom and four-bath residence set off the first tee of the championship golf course. The Cottage is the perfect venue for executive meetings and small groups as well as retreat getaways.



The Ballantyne Hotel & Lodge
10000 Ballantyne Commons Parkway
Charlotte, North Carolina 28277
866.248.4824
sales@theballantynehotel.com
www.theballantynehotel.com



*Life is a collection of experiences.
Let us be your guide.*



Known for accessibility, versatile event space, desirable amenities and superior service, The Ballantyne Hotel & Lodge, a member of Starwood's The Luxury Collection, offers a variety of unique venues for meetings, weddings and social gatherings. Conveniently located just 20 minutes from Charlotte-Douglas International Airport and nearby a variety of enriching area attractions, The Ballantyne Hotel & Lodge features on-site offerings such as spa, fitness services, golf, Dana Rader Golf School, tennis, indoor and outdoor pools and dining at Gallery Restaurant.

With thoughtfully designed indoor and outdoor event space, including 25 meeting rooms, two ballrooms, a golf pavilion and two event lawns, The Ballantyne Hotel & Lodge is committed to delivering the total meeting and social event experience.



The Ballantyne Hotel: Main & Mezzanine Levels

ROOM	METER	FEET	SQ. M	SQ. FT.	HEIGHT	DINNER	RCPTN	DANCE	THTR	U-SHAPE	CLSRM	CONFR	CRSNT
VERANDA	25 x 3	82 x 11	75	902									
AZALEA	7 x 4	25 x 13	28	325	10	12							12
BRADFORD	8 x 4	27 x 13	32	351	10								
DOGWOOD	8 x 4	27 x 13	32	351	10	12							12
MAGNOLIA	8 x 4	27 x 13	32	351	10								
WILLOW	8 x 4	27 x 13	32	351	10	12							12
BALLANTYNE BALLROOM	27 x 21	89 x 70	567	6230	16	400	500	350	600		280	90	280
BALLANTYNE A	21 x 9	70 x 29	189	2030	16	140	180	120	200	60	80	46	88
BALLANTYNE B	21 x 8	70 x 29	168	2030	16	140	180	120	200	60	80	46	88
BALLANTYNE C	9 x 7	30 x 23	63	690	16	30	35		45	16	24	20	24
BALLANTYNE D	9 x 7	30 x 24	63	720	16	30	35		48	20	30	20	24
BALLANTYNE E	9 x 7	30 x 23	63	690	16	30	35		45	16	24	20	24
BALLROOM FOYER B	19 x 3	63 x 9	57	567	16								
BALLROOM FOYER D	24 x 4	78 x 13	96	1014	16								
BISSELL	5 x 5	18 x 18	25	324	8	14	18		20	12	16	14	
HARRIS	5 x 5	18 x 18	25	324	8	14	18		20	12	16	14	
MORRISON	9 x 4	30 x 15	36	450	8	14	18		20	12	16	14	

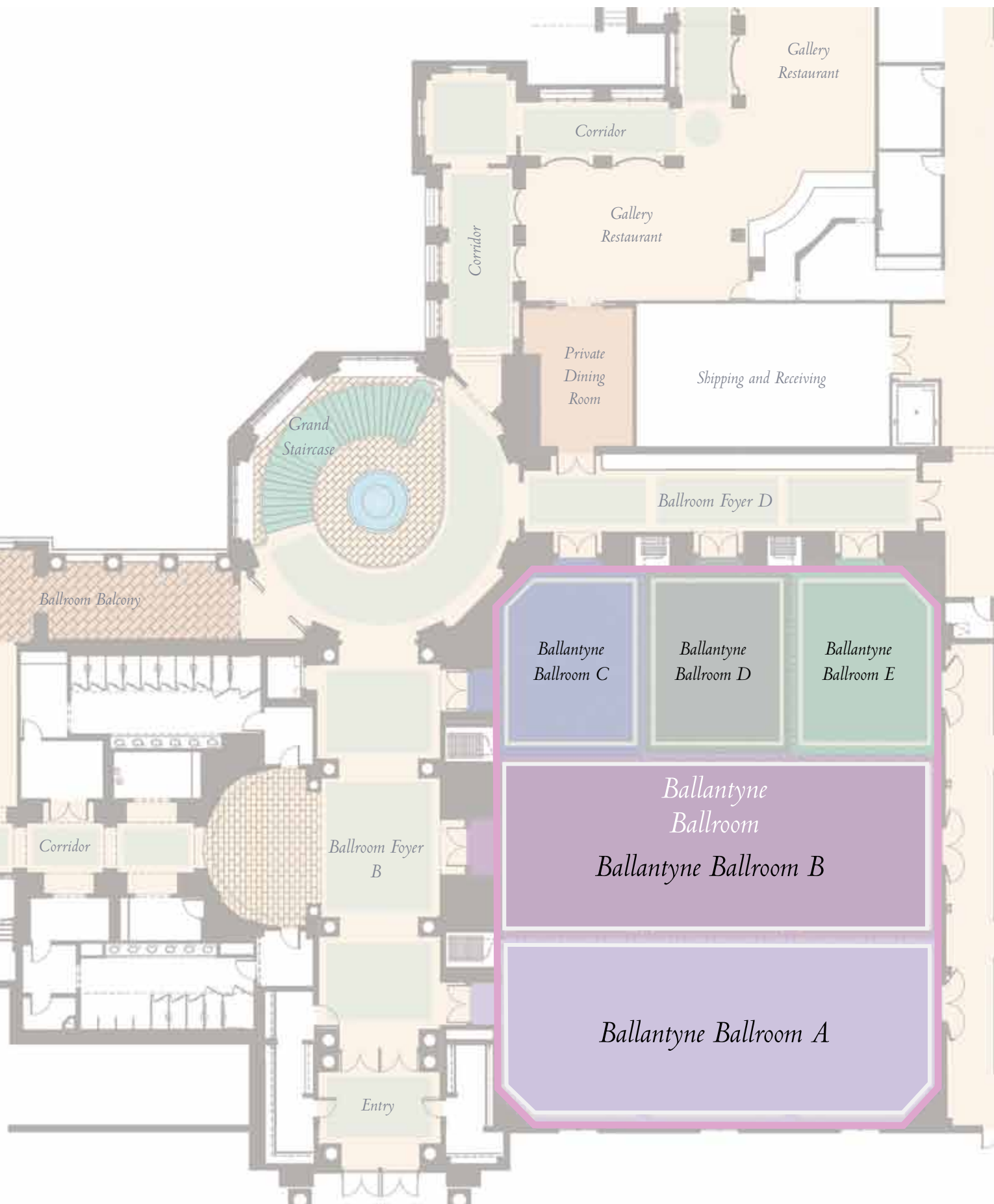

The Ballantyne Hotel: Lower Level

ROOM	METER	FEET	SQ. M	SQ. FT.	HEIGHT	DINNER	RCPTN	DANCE	THTR	U-SHAPE	CLSRM	CONFR	CRSNT
YORK	14 x 6	46 x 19	84	874	10	50	60	30	80	24	32	34	32
YORK A	7 x 6	23 x 19	42	437	10	20	25		36	14	18	16	16
YORK B	7 x 6	23 x 19	42	437	10	20	25		36	14	18	16	16
YORK FOYER	14 x 3	46 x 12	42	552	10								
UNION	17 x 18	56 x 26	136	1456	10	80	100	60	130	40	60	46	48
UNION A	8 x 5	26 x 18	40	468	10	20	25		36	14	22	12	12
UNION B	8 x 6	26 x 21	48	546	10	30	35		48	18	24	20	18
UNION C	8 x 5	26 x 18	40	468	10	20	25		36	14	22	12	12
UNION FOYER	14 x 3	48 x 12	42	576	10								
TERRACE	20 x 3	66 x 12	60	792		60	100						
ATRIUM						60	400		120				

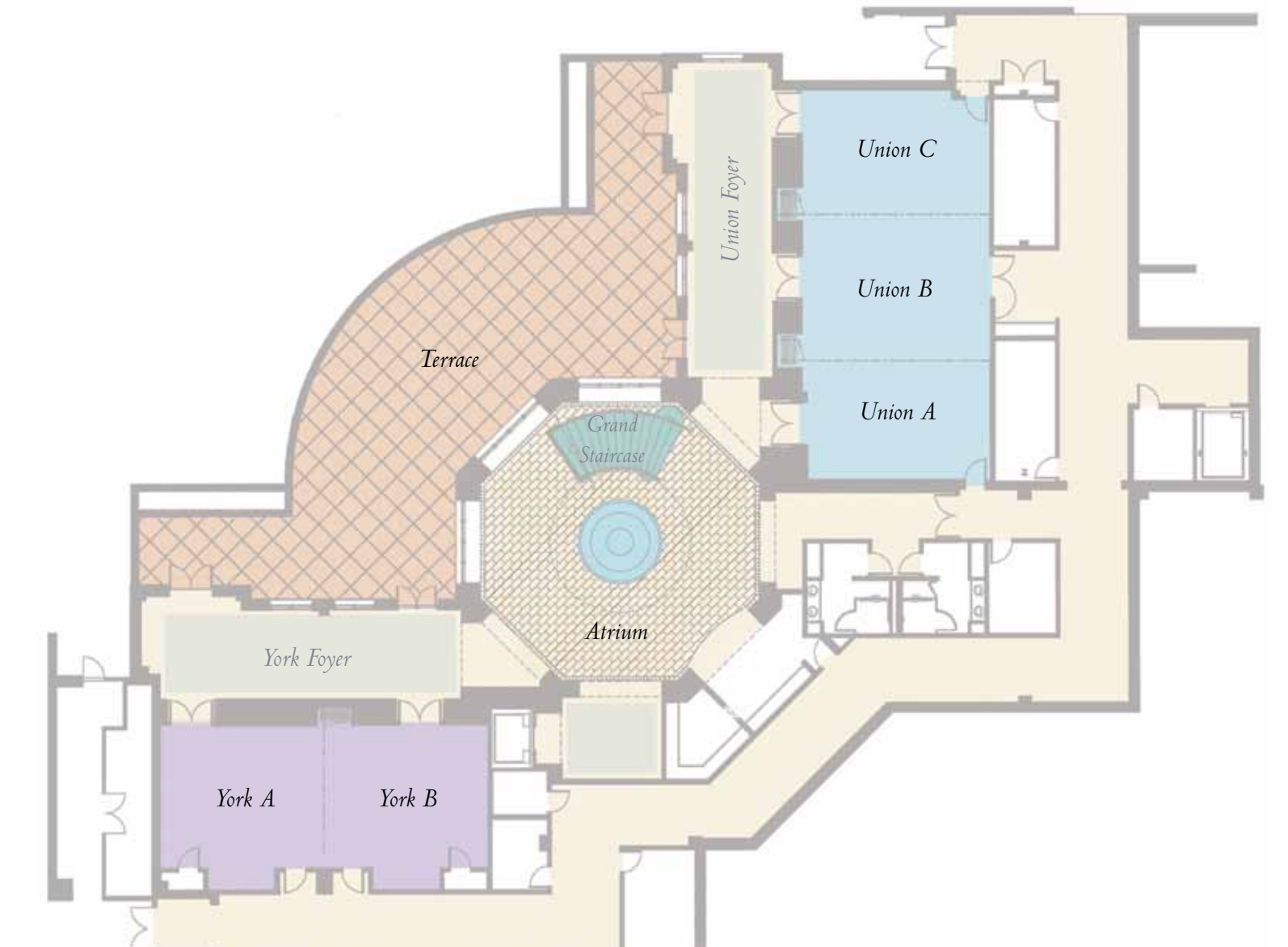

The Ballantyne Hotel: Lower, Main & Upper Levels

ROOM	METER	FEET	SQ. M	SQ. FT.	HEIGHT	DINNER	RCPTN	DANCE	THTR	U-SHAPE	CLSRM	CONFR	CRSNT
GREAT ROOM	11 x 8	36 x 27	88	972	12		150						
BALCONY	50 x 5	164 x 16	250	2624			60						
CLUBHOUSE BOARDROOM	8 x 4	26 x 14	32	364	11	12							12
OVERLOOK	7 x 7	25 x 25	49	625	11	40	45		40	20	20	20	32
FAIRWAY BALLROOM	27 x 12	90 x 39	324	3510	11	180	200	150	220	40	110	60	108
FAIRWAY A	7 x 5	24 x 18	35	432	11	20	25		40	12	16	16	16
FAIRWAY B	16 x 12	54 x 39	192	2106	11	120	130	80	175	28	80	48	72
FAIRWAY C	7 x 5	24 x 18	35	432	11	20	25		40	12	16	16	16
FAIRWAY FOYER	27 x 3	88 x 10	81	880	11								
SOUTH LAWN	12 x 15	40 x 50	180	2000		200	350	200	180				
GOLF PAVILION	10 x 13	38 x 40	130	1520		60	100						

